

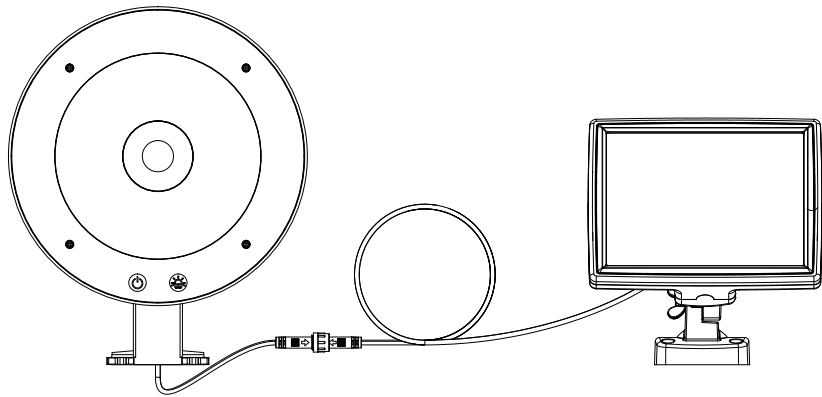

# Installation Guide

## Outdoor Style Security Area Light Solar



www.gelighting.com  
GE is a trademark of General Electric Company. Used under trademark license.  
©2024 Savant Systems LLC. Information provided is subject to change without notice.  
All values are design or typical values when measured under laboratory conditions.

### PRODUCT COVERED

OUTARSL12075CBKN

### DIMMING

The luminaire is non-dimmable.



#### BEFORE YOU BEGIN

Read these instructions completely and carefully. Before installing the light fixture, ensure that all parts are present. Installation should follow national and local codes.

### WARNING

- Risk of fire or electric shock. Installation requires knowledge of luminaire electrical systems. If not qualified, do not attempt installation. Contact a qualified electrician.
- These products are intended to be used in wet locations.
- These products are suitable for wall mount installation.
- The battery in these devices is not user serviceable. Do not incinerate. Recycle according to local regulations.

To prevent sensor malfunctions, operational failure or any deterioration of its characteristics, do not use this sensor in the following, or similar conditions.

- In rapid environmental temperature changes
- In strong shock or vibration.
- In a place where there are obstructing materials (Glass, Fog, etc.) through which infrared rays cannot pass within detection area.
- In fluid, corrosive gases and sea breeze.
- Continual use in high humidity atmosphere.
- Exposed to direct wind from a heater or air conditioner.

To help keep the battery charged:

- Remove obstructions that block the solar panel from receiving direct sunlight.
- Mount the solar panel facing south with a vertical tilt of 25-45 degrees.
- Keep the solar panel surface clean.
- Do not place the fixture next to heaters or heat-emitting devices.

**NOTE:** This device complies with part 15 of the FCC Rules. Operation is subject to the following two conditions: (1) This device may not cause harmful interference, and (2) this device must accept any interference received, including interference that may cause undesired operation.  
Visit [www.gelighting.com/regulatory](http://www.gelighting.com/regulatory) for more information.

### PACKAGE CONTENTS

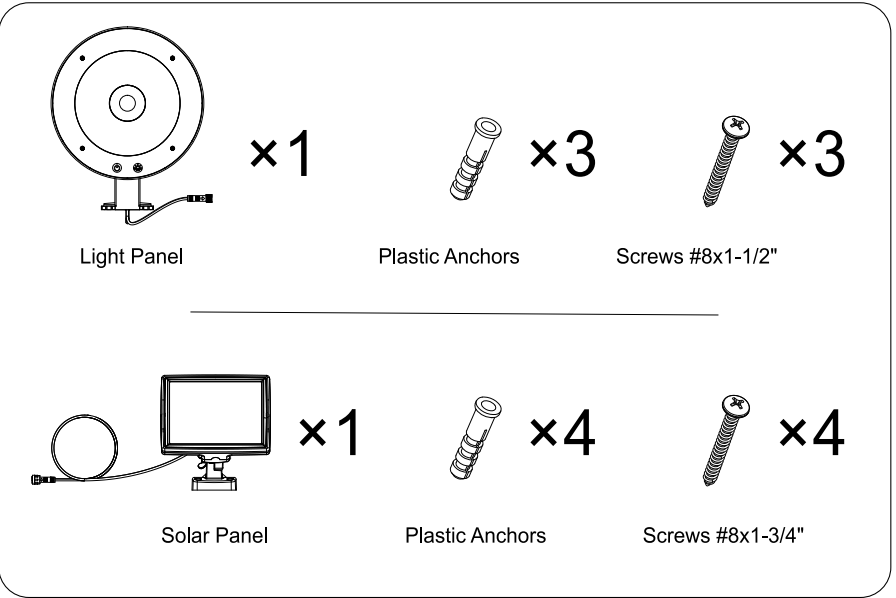

### TOOLS REQUIRED

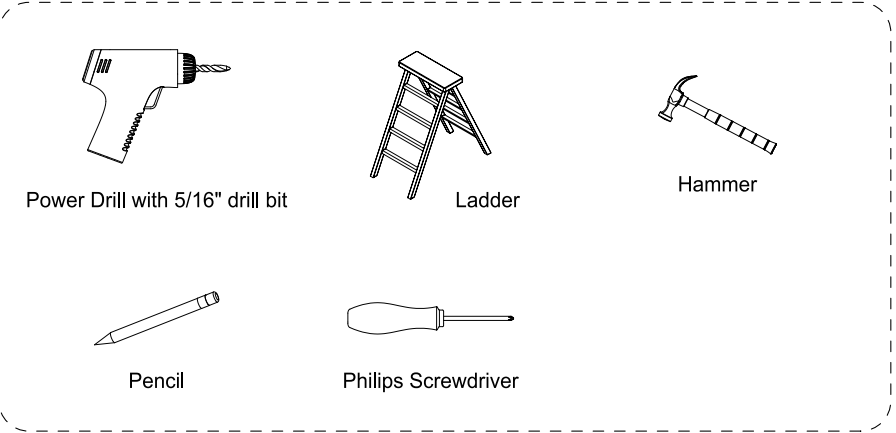

### BEFORE INSTALLATION

Before installation, confirm that the fixture lights up and choose the desired brightness level and color temperature, as shown in steps 1 & 2.

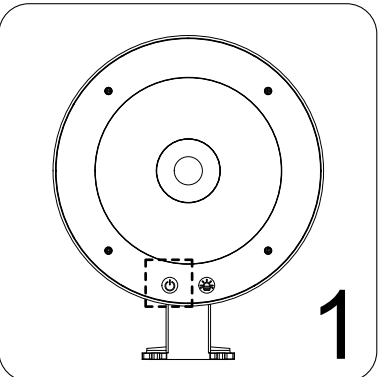

**Press the On/Off button to test the fixture.** It will light up for about 4 seconds.

**NOTE:** This fixture contains a rechargeable battery. If the fixture does not turn on, please charge it for a few hours under sunlight. Then press the On/Off button to confirm that the light panel is functioning.

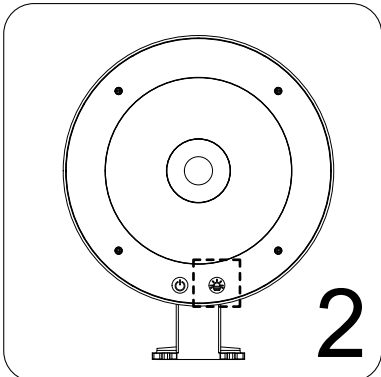

**Set preferred color temperature.** Press the CCT button to change the color temperature. The default setting is 6500K. Continue pressing button to select color: 5000K-4000K-3000K-2700K, then back to 6500K.

Select from these white tone settings:  
**2700K 3000K 4000K 5000K 6500K**  
soft warm cool daylight cool  
white white white daylight

### PRODUCT PERFORMANCE DETAILS

It typically takes approximately 8 hours for the battery to charge fully when exposed to sunlight. When fully charged, the light can come on up to 120 times when motion is detected. The light will stay on for 30 seconds after the last motion is detected. This fixture is equipped with a motion sensor. The typical detection angle is 360 degrees and typical detection range is 15ft. when the fixture is mounted 10 ft above ground.

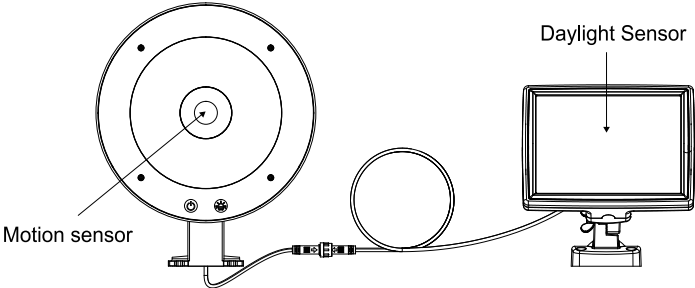

### INSTALLATION

This fixture is suitable for wall and eave mounting. Recommended install height is 8ft. to 11ft. (2.4m to 3.4m) above the ground.

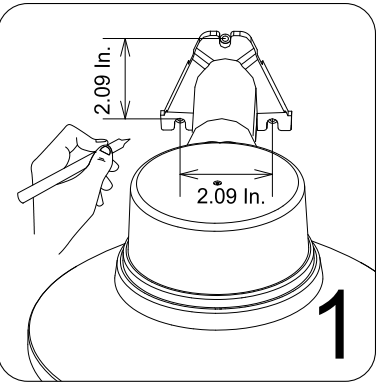

Place the light panel flush to the mounting surface with the light facing down. Mark the three hole locations. Put the panel aside and drill three pilot holes using 5/16" drill bit.

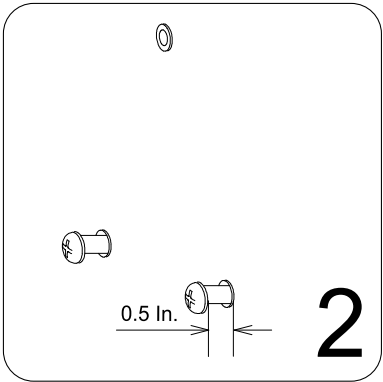

Use a hammer to gently tap the plastic anchors into the pilot holes. Ensure that the anchors are tapped all the way in. Insert the screws in the two bottom plastic anchors and tighten using a screwdriver to within 0.5" of the wall.

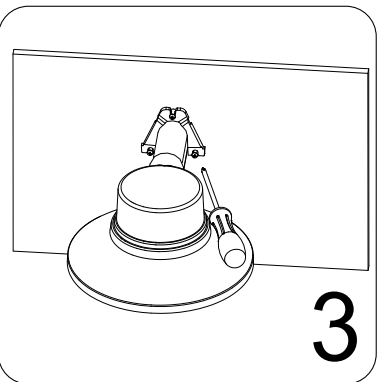

Use the bottom two screws to anchor the light panel to the mounting surface. While holding the light panel in place, insert the screw in the top plastic anchor. Tighten all three screws to secure the light panel to the mounting surface.

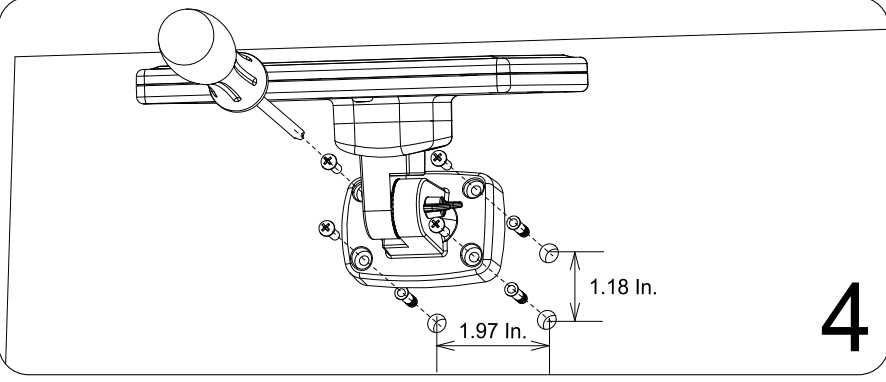

The solar panel should be mounted in a south facing location exposed to sunlight (must be within 118" from the light panel). Hold the solar panel in place and mark the four hole locations on the mounting surface. Put the solar panel aside and use a 5/16" drill bit to create four pilot holes. Insert plastic anchors same as in step 2. Align the holes of the solar panel mounting bracket to the plastic anchors and use the screws to secure the solar panel to the mounting surface.

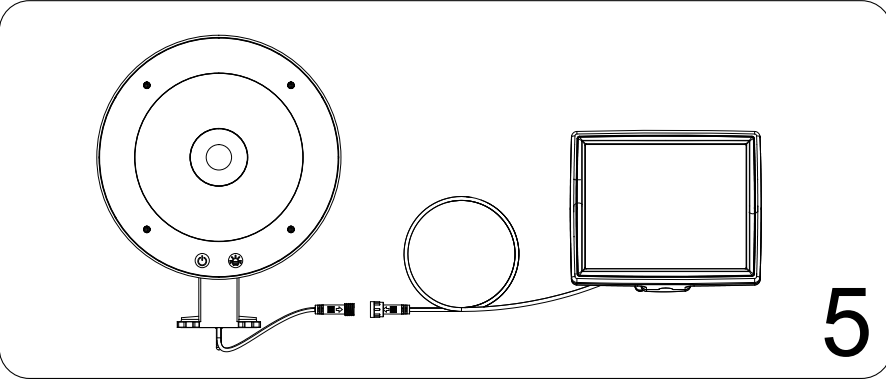

Connect the wire between solar panel and light engine. It is recommended to install the solar panel facing south and with a vertical tilt of 25-45 degrees. Press the On/Off button to turn on the fixture. Note that the fixture will turn on for 4 seconds and will turn off if daylight is sensed.

### TROUBLESHOOTING

Problem	Possible Cause	Solution
Light does not turn on	Battery is not sufficiently charged	Connect the solar panel and charge it for a few hours under sunlight. Then press the On/Off button to confirm that the light panel is functioning.
	The fixture is sensing daylight	Cover the daylight sensor with one hand and wave the other hand in front of the motion sensor. The fixture should come on after a short delay. Unit will switch ON after a short delay.
Light does not turn off during daytime	The light sensor is in a heavily shaded area	Shine a flashlight into the light sensor for 1 minute. If the fixture turns off, it needs to be moved to a location with enough light in the daytime.
The light stops responding to motion during the night	Battery is not sufficiently charged	Ensure the solar panel receives adequate sunlight during the day.
	The solar panel is obstructed, for example mounted in a shaded area	Move the solar panel to an area that receives sunlight. It is recommended to mount the solar panel facing south and with a vertical tilt of 25-45 degrees.
	The ambient temperature during the day is below 32 F	To ensure battery safety, there is an internal temperature sensor in the fixture that prevents battery charging when temperature is below 32F. Once the ambient temperature goes up, the battery charging will resume
	The ambient temperature during the day is above 99 F	To ensure battery safety, there is an internal temperature sensor in the fixture that prevents battery charging when temperature is above 99F. Once the ambient temperature goes down, the battery charging will resume.

If these troubleshooting tips do not solve your issue, then contact our customer support team at 1-800-435-4448.